

### Rückansicht Stützwall M. 1:500

km = 0 - 108,135  
TS = 697,678  
H = 150,000  
F = 0,000

km = 0 - 167,148  
TS = 699,036  
H = 150,000  
F = -0,768

km = 0 - 263,667  
TS = 693,275  
H = 100,000  
F = 0,313

km = 0 - 313,637  
TS = 692,862  
H = 50,000  
F = 0,189

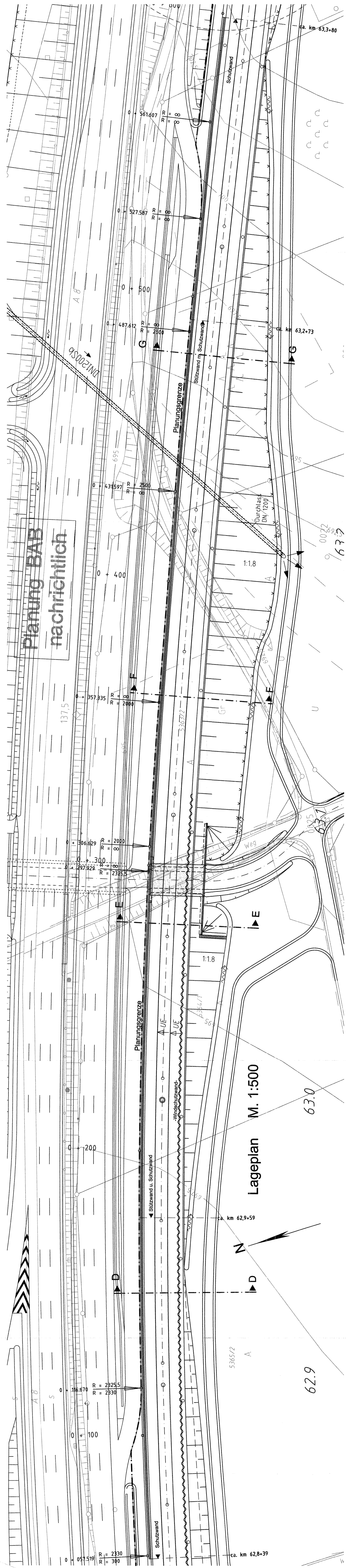
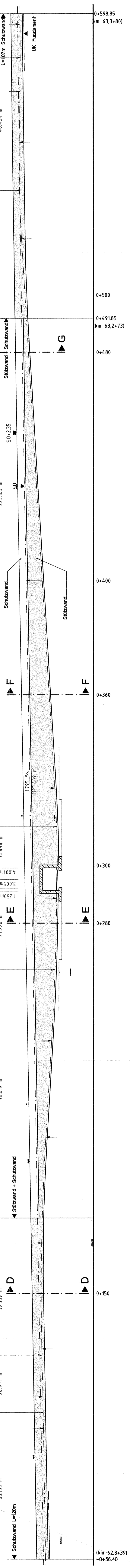

### Schnitt D-D Stützwall km 0 + 150 M.1:100

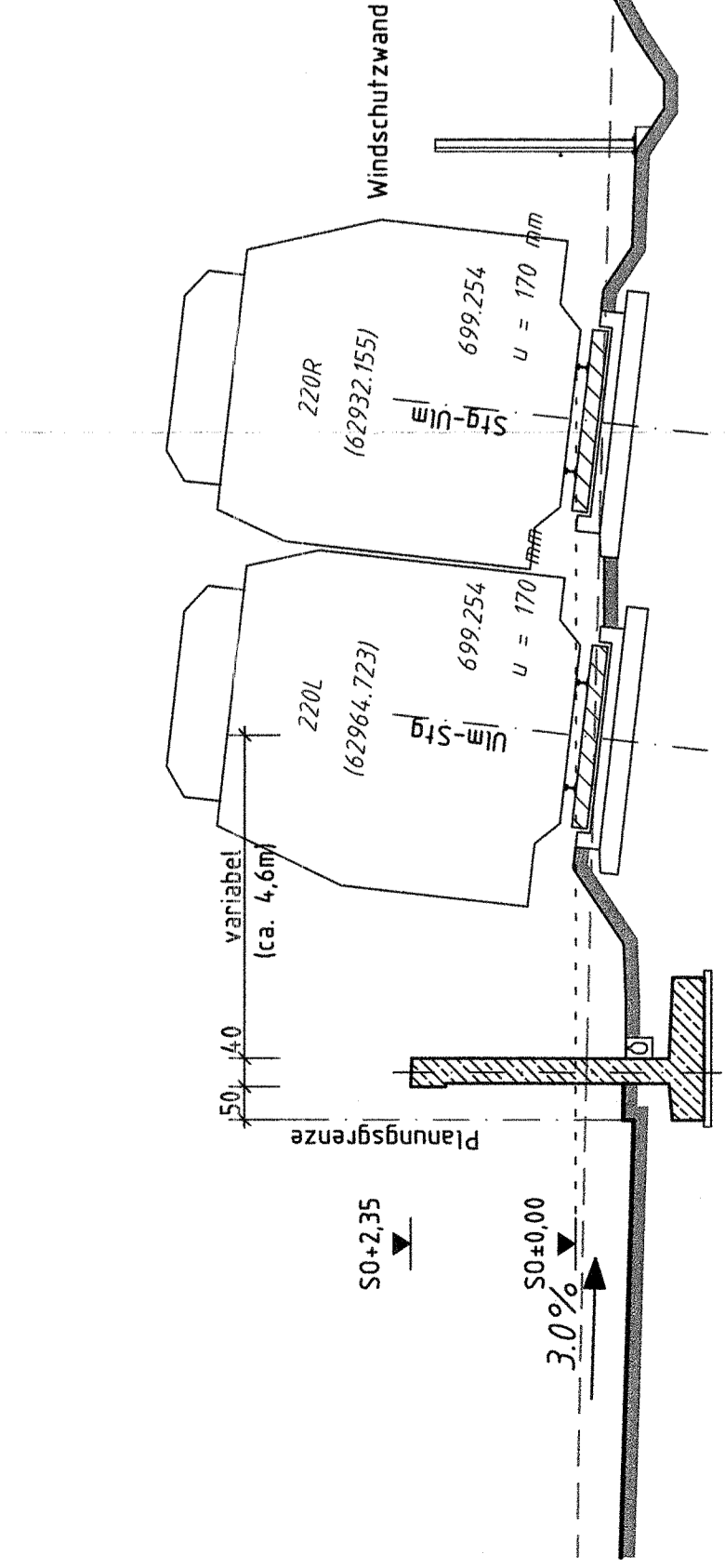

### Schnitt E-E Stützwall km 0 + 280 M.1:100

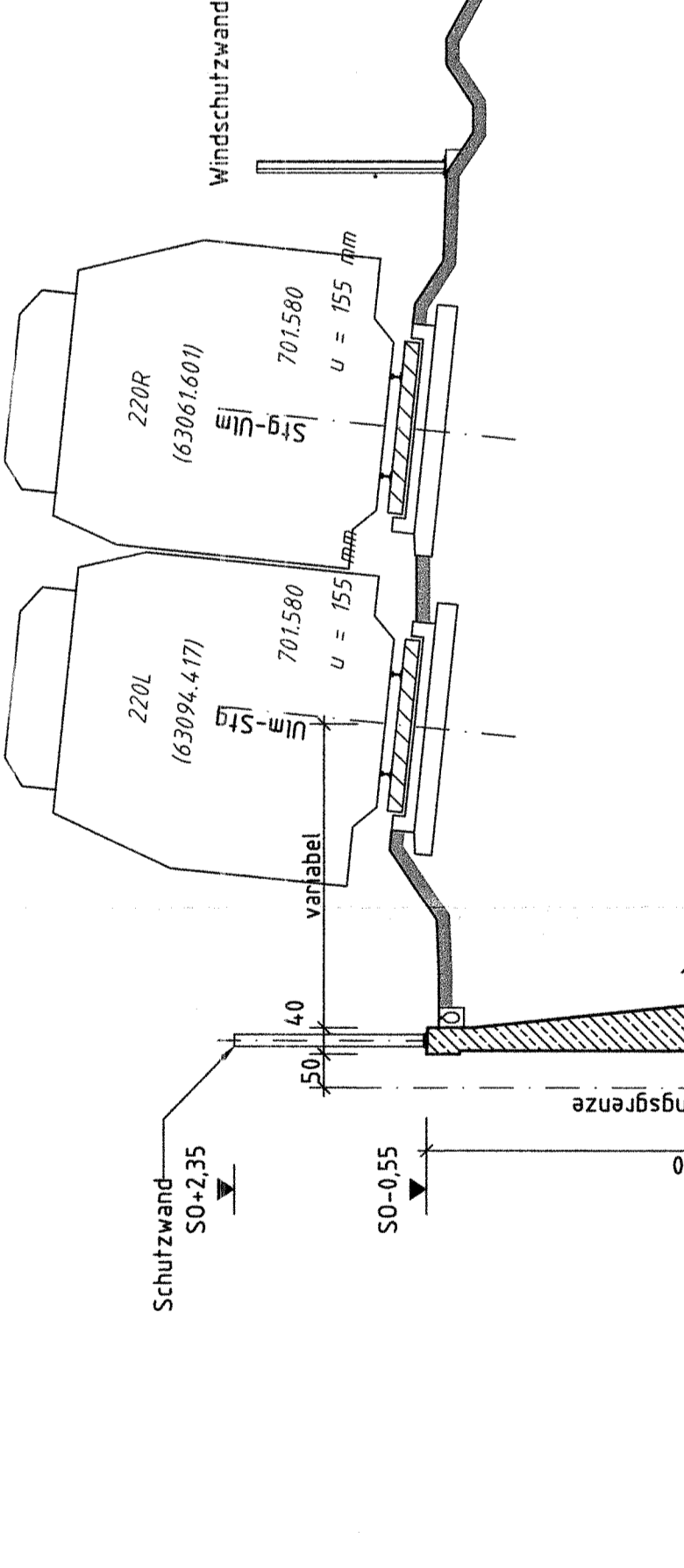

### Schnitt F-F Stützwall km 0 + 380 M.1:100

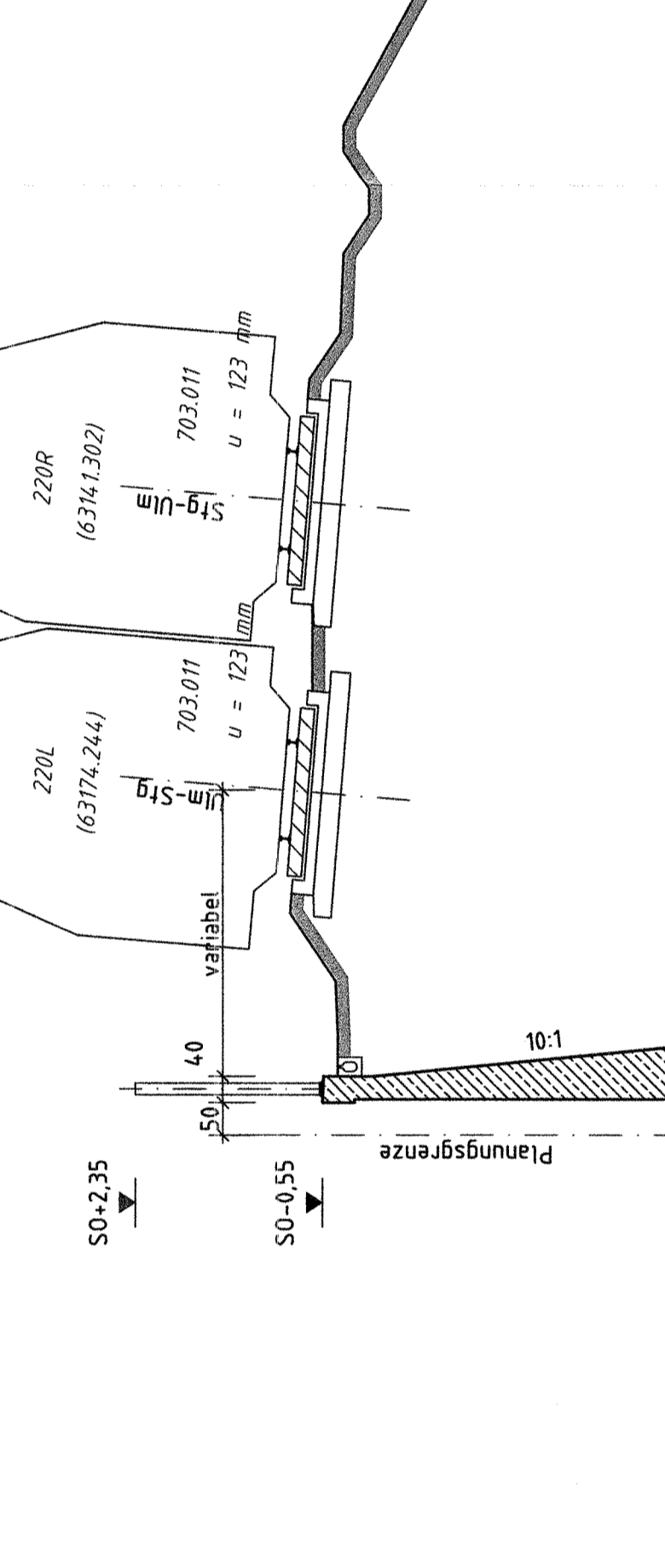

### Schnitt G-G Stützwall km 0 + 480 M.1:100

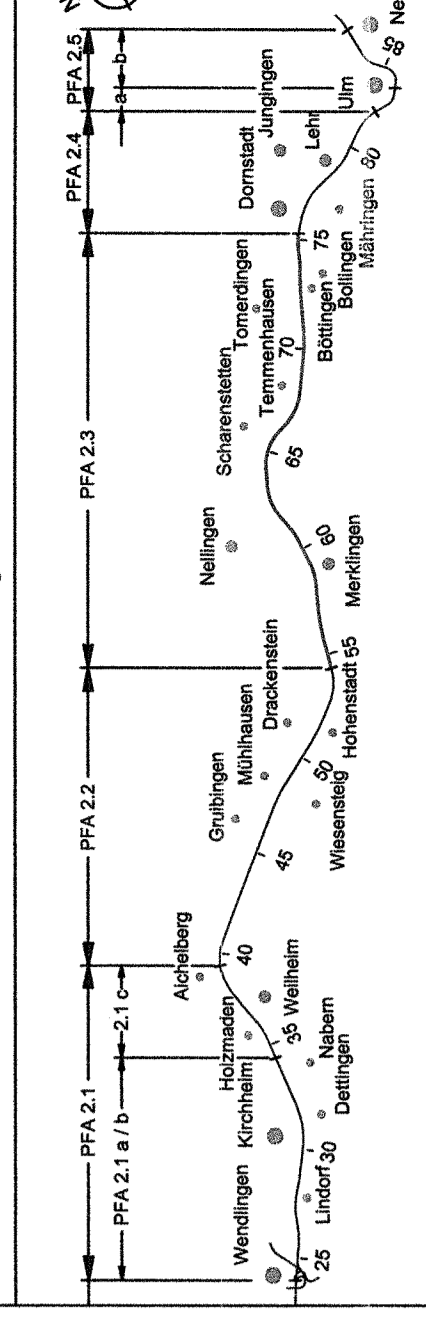
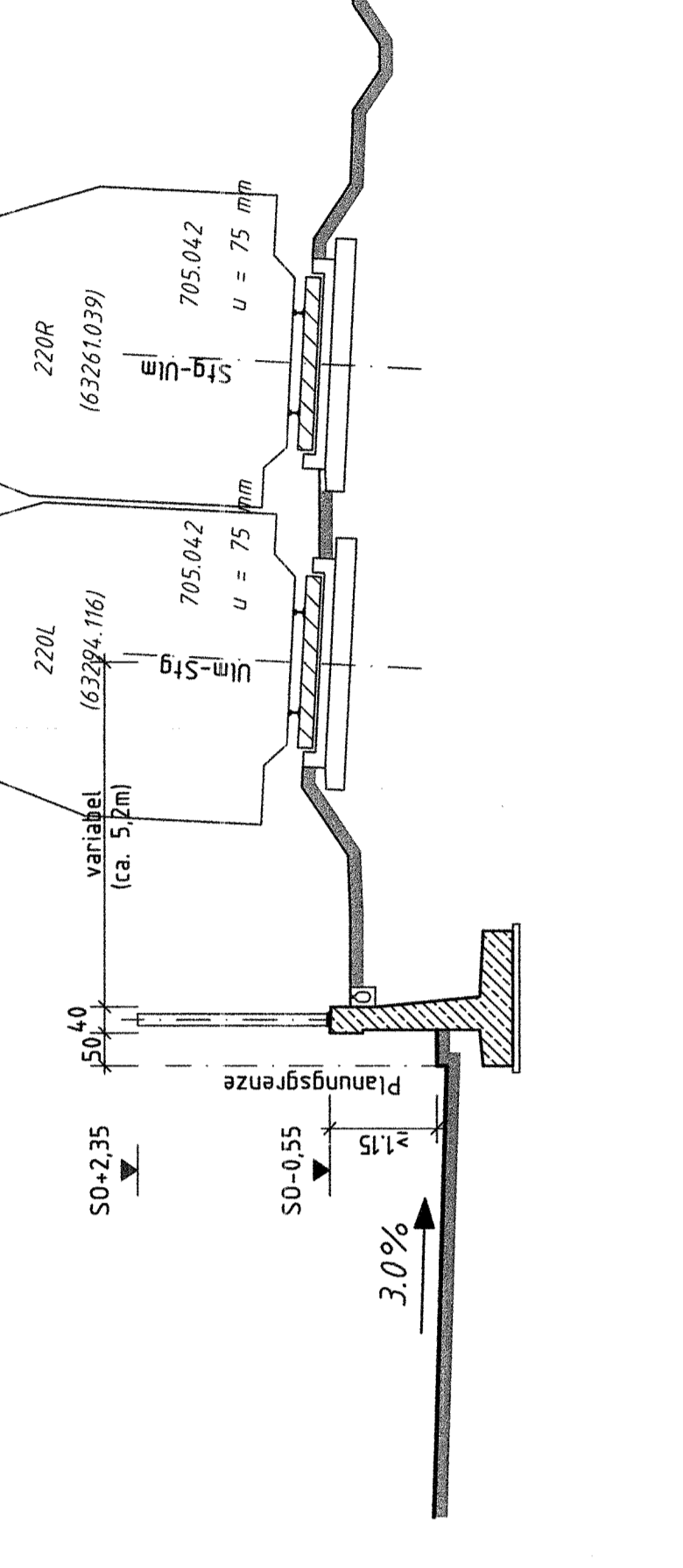

Geographische Codierung		Bleibende Codierung		Dynamische Codierung	
2	3	4	8	1	3
0	0	3	1	1	3
0	0	3	1	1	3

**DB**

**OBERMEYER**  
Plan- und Ingenieurbüro  
Königsplatz 31  
70372 Stuttgart  
Tel. 0711 7062-1700  
Fax 0711 7062-1705

**DB Projektbau GmbH**  
Königsplatz 31  
70372 Stuttgart  
Tel. 0711 7062-1700  
Fax 0711 7062-1705

**i.V. bayern**  
Stuttgart, den 23.09.2005

**NUR ZUR INFORMATION**

Uphersichtsrechte bei der DB AG

Blatt 5 von 12